



DESCRIPTION AND APPLICATIONS

Monodeck G5 modified bitumen self-supporting panel is made with a steel sheet on the inner side, an external sheet of bitumen modified with LBM type elastomer for subsequent placement on the final finishing fabric and a rigid polyurethane foam core with great thermal insulation.

Designed for flat roofs applications with a minimum slope of 1%.

La longitud máxima podrá ser de hasta 15.000 mm con un ancho útil de 1.000 mm.

PRODUCT CERTIFICATION

Certificate of conformity.

ADVANTAGES

The advantages on being a prefabricated panel are the easiness and quickness in the assembly, the homogeneity and the quality of finishes reflected in the certifications.

Además con la instalación de un solo elemento damos solución al soporte, el aislamiento y la impermeabilización o pre-impermeabilización de la cubierta.

FIRE REACTION

Classification F meeting UNE- EN 13501-1:2007 +A1:2010 specifications. Free of CFC.

PRODUCT CHARACTERISTICS

Maximum spans recommended.

T=ICKNESS	± EIG=T	T ERMA TRANSMITTANCE		S ANS m				S ANS m			
		U m		OVER OA daN m				OVER OA daN m			
		U ith OINT ACTOR	U ithout OINT ACTOR								
		U ith OINT ACTOR	U ithout OINT ACTOR	OVER OA daN m				OVER OA daN m			

PANEL SECTION

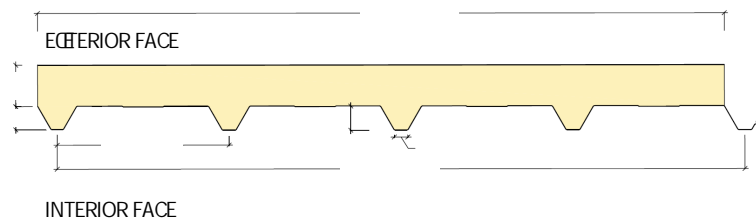

PANEL JOINT

Visible fixing

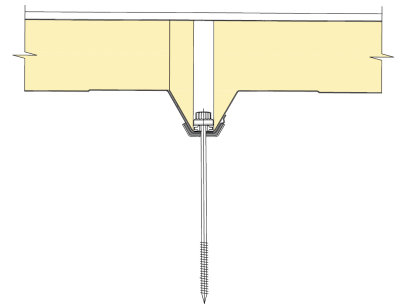

3D ESTRUCTURE

