

DESCRIPTION AND APPLICATIONS

METCOVER 2000 is a system designed for industrial rooflights available for available for roof applications. It is a mechanical solution with a 100% watertight seal, providing complete waterproofing. Its geometry allows a perfect adaptation to different metal sandwich panels. It consists of a system of surprisingly light microcells with a unique design.

Minimum slope of 10%.

MEASUREMENTS AND TECHNICAL CHARACTERISTICS

Maximum length	34 metres
Thickness	30 mm
Width	1.000 mm
Structure	Honeycomb
Standard colour	Light opal
Light transmission	39%
Solar factor	0,46
Thermal insulation	1,60 W/m ² °C
U.V. protection	Yes
Both edges taped	Porous aluminium tape

PRODUCT CERTIFICATIONS

CE Marking	EN 14782
Manufacturing requirements	EN 16153
Classification reaction to fire B-s1, d0	EN 13501

SPECIAL FINISHES AND FABRICATIONS

Softlite®	Anti-glare
Light transmission	Customised*
Colours	Consult range*

*Consult with the technical department.

METCOVER 2000 SYSTEM STRUCTURE

METCOVER 2000 polycarbonate panel.
Specific clamps to attach to the metal pan.
Closing units: at the beginning and end of the panel.

POLYCARBONATE DETAIL WITH STRAP FITTING

Practice carried out when the thickness of the sandwich panel is greater than that of the METCOVER 2000 polycarbonate.

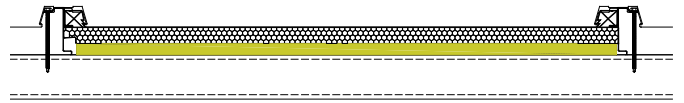

PANEL-POLYCARBONATE JOINT

Concealed screws.

Standard delivery of staples: 1,5 pcs./m²

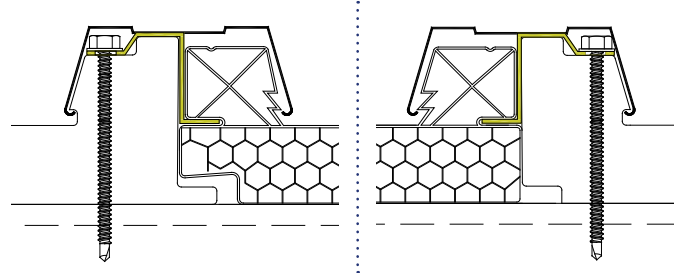

RECOMMENDED MAXIMUM DISTANCE BETWEEN PURLINS DEPENDING ON THE LOAD

Permissible loads (Kg/m²) as a function of the distance between supports (mm).

		75 Kg/m ²	100 Kg/m ²
PRESSURE	2 supports	1.400	1.150
	3 or more supports	2.600	2.200
SUCTION	2 supports	1.150	1.000
	3 or more supports	2.000	1.800

NOTE: The values given in the table are permissible loads without increasing and must be compared with the sum of the characteristic loads of each project.

Tables valid only for pre-dimensioning. The designer must carry out the structural calculation in accordance with the applicable regulations. METECNO ESPAÑA S.A.U. expressly declines any responsibility derived from the use of these tables.